

scale -1"=12"

Drawn by Gary S. Reuter  
University of Minnesota  
Dept. of Entomology  
04-13-01

# Bulk Bee Box 1 of 2

Standard design with modifications by  
USDA lab Baton Rouge

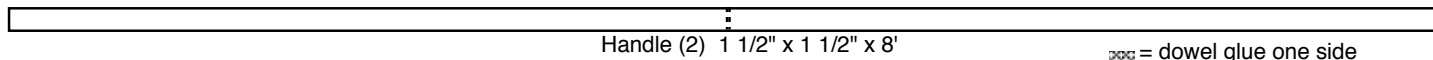
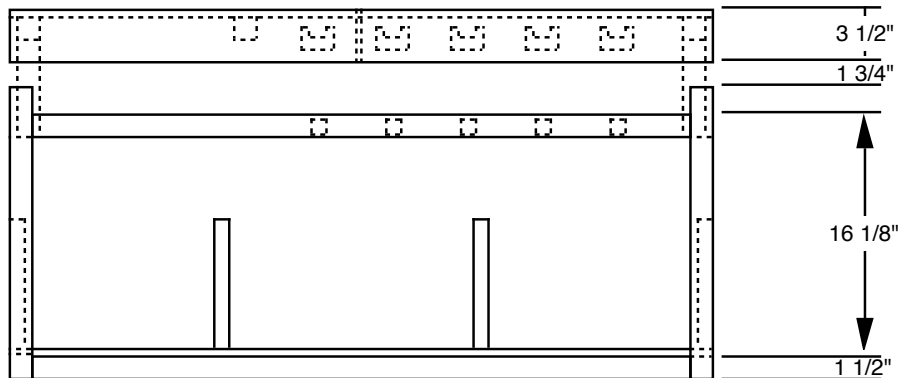
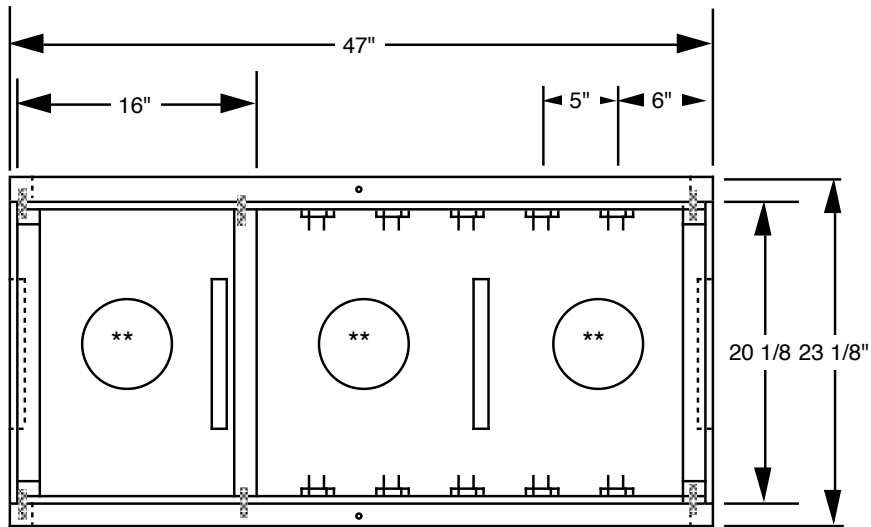

Material List	
<b>2x Fir</b>	<b>1/2" plywood</b>
2 - 1-1/2 x 3-1/2 x 47" top rail	1 - 1/2 x 23 1/8 x 47" bot
1 - 1-1/2 x 1-1/2 x 20-1/8" opening end	2 - 1/2 x 8 x 46" side
4 - 1-1/2 x 1-1/2 x 44" side top & bot	2 - 1/2 x 8 x 20-1/8" end
4 - 1-1/2 x 1-1/2 x 19-1/2" side end	3 - 1/2 x 15 7/8 x 20" top
2 - 1-1/2 x 1-1/2 x 6-1/2" corner	8 - 1/2 x 9 x 10" arches (mill)
2 - 1-1/2 x 1-1/2 x 8" corner	
2 - 1-1/2 x 1-1/2 x 96" handle	<b>8x8 hardware cloth</b>
4 - 1-1/2 x 1-1/2 x 20-1/8" end top & bot	2 - 16 1/2 x 46" side
	2 - 16 1/2 x 22" end
	1 - 24 x 47" vent
<b>#2 Pine</b>	<b>hardware</b>
4 - 3/8 x 3/4 x 48" end	1 1/4" screws
4 - 3/8 x 3/4 x 22" side	3" screws
8 - 3/8 x 3/4 x 18" vertical	2 - 1/4" x 5" pin (handle)
10 - 3/8 x 2-1/8 x 1-1/2" frm holder (mill)	2 - 1/16 x 2 x 48" metal (top)
3 - 3/4 x 2 x 19" cover hdl	36" - 3/4" metal strapping
	25 - 3/8" x 1-1/4" wood dowels

lumber needed —

- 7 - 2x2x8'
- 1 - 2x4x8'
- 1 - 1/2x4x8' ply
- 1 - 1x6x8' pine

\*\* optional 6" vent(s)

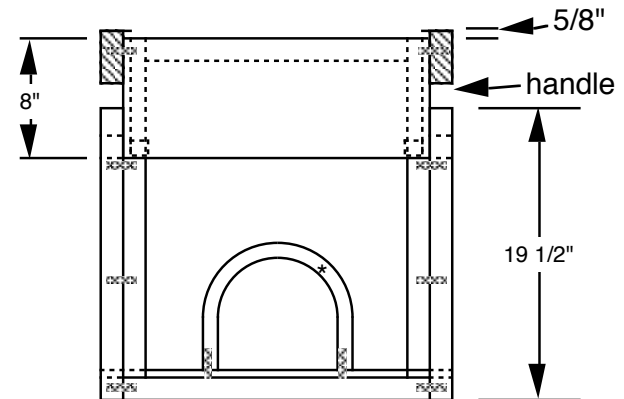

\* see pg. 2

□ = dowel glue one side

scale -1"=2"

# Bulk Bee Box 2 of 2

Standard design with modifications by  
USDA lab Baton Rouge

Drawn by Gary S. Reuter  
University of Minnesota  
Dept. of Entomology  
04-13-01

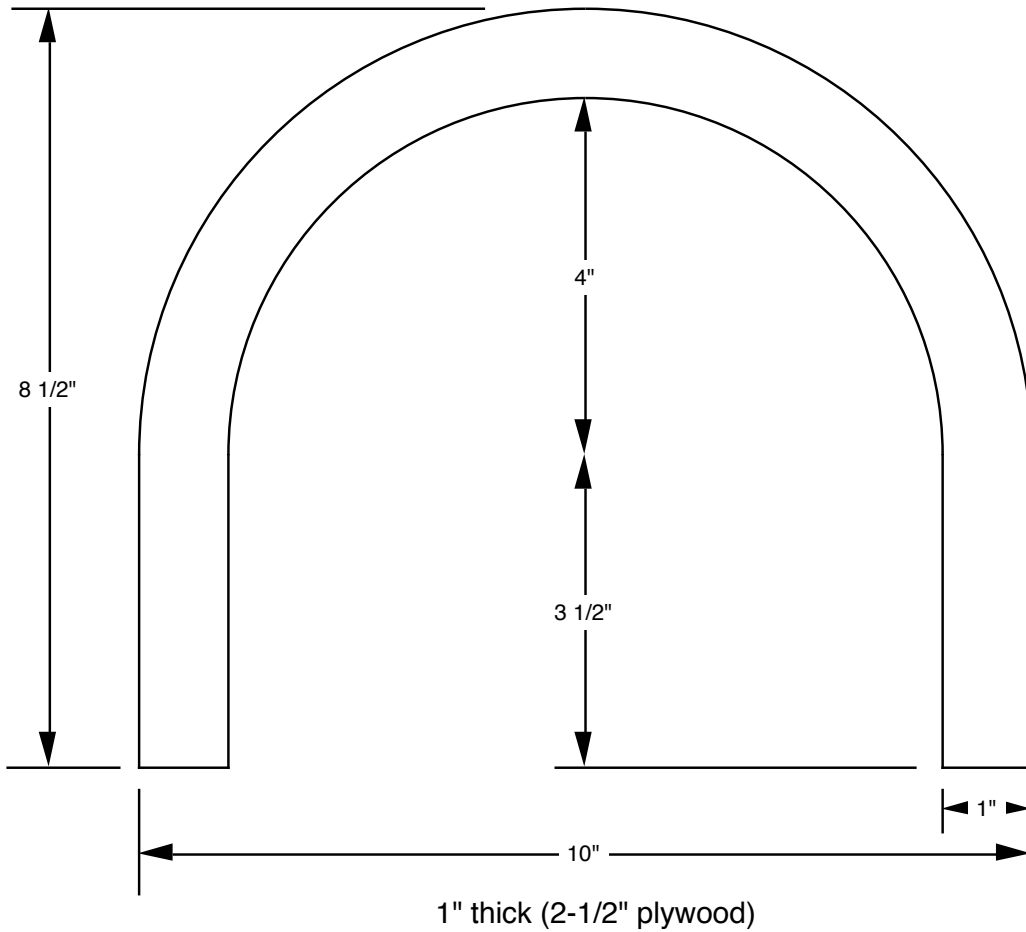

1" thick (2-1/2" plywood)  
**Vent support**

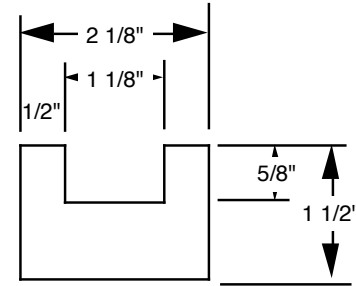

3/8" thick  
**Frame rest**

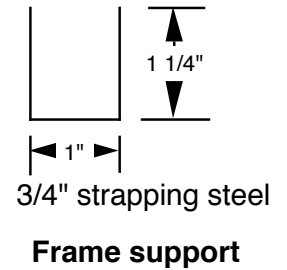

3/4" strapping steel  
**Frame support**

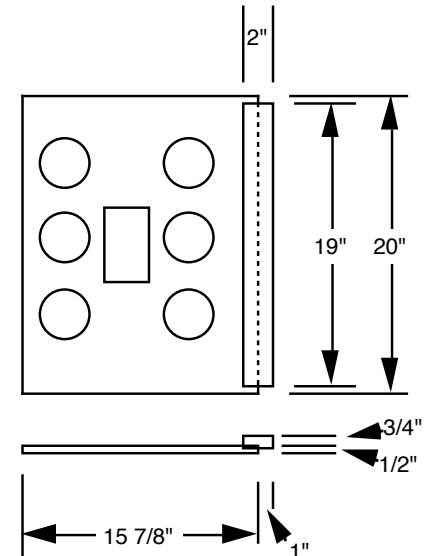

**covers (3)** Screened holes for vents/  
feeding/shaking bees